

Feudal Fun

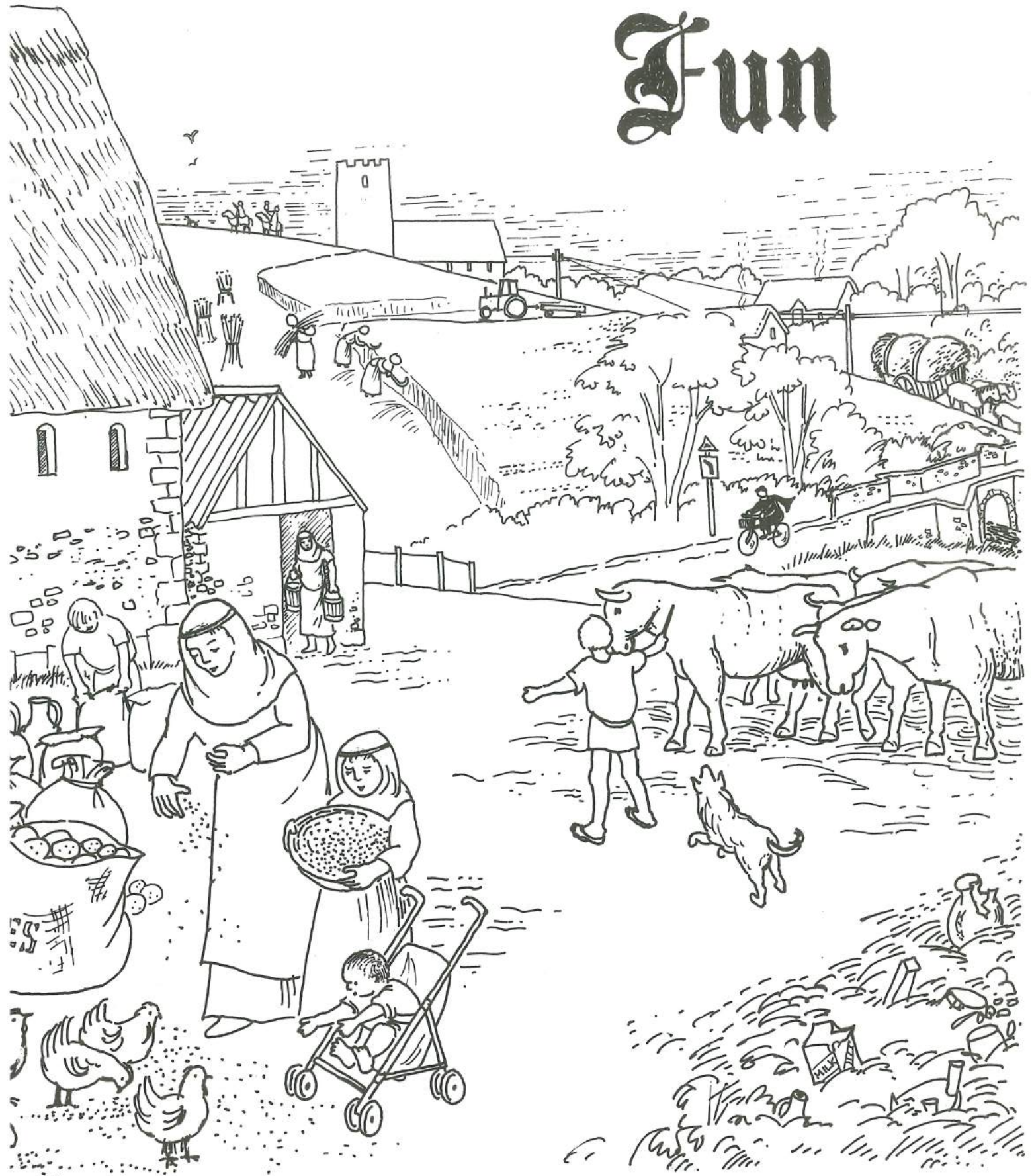

The Dig

This is a section through an archaeological excavation. Match each dated object to the layer from which it was dug.



1,000 B.C.
flint
arrowhead

fourteenth
century
candlestick

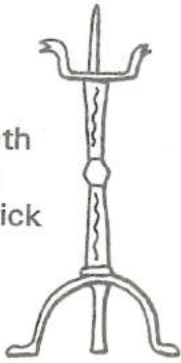

A.D.337
-340
coin

A.D.1361
-1365
coin



twentieth
century
drink
can

fifteenth
century
key

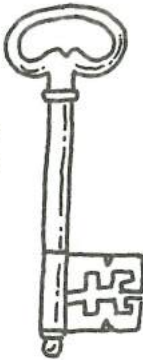

fourth
century
jar

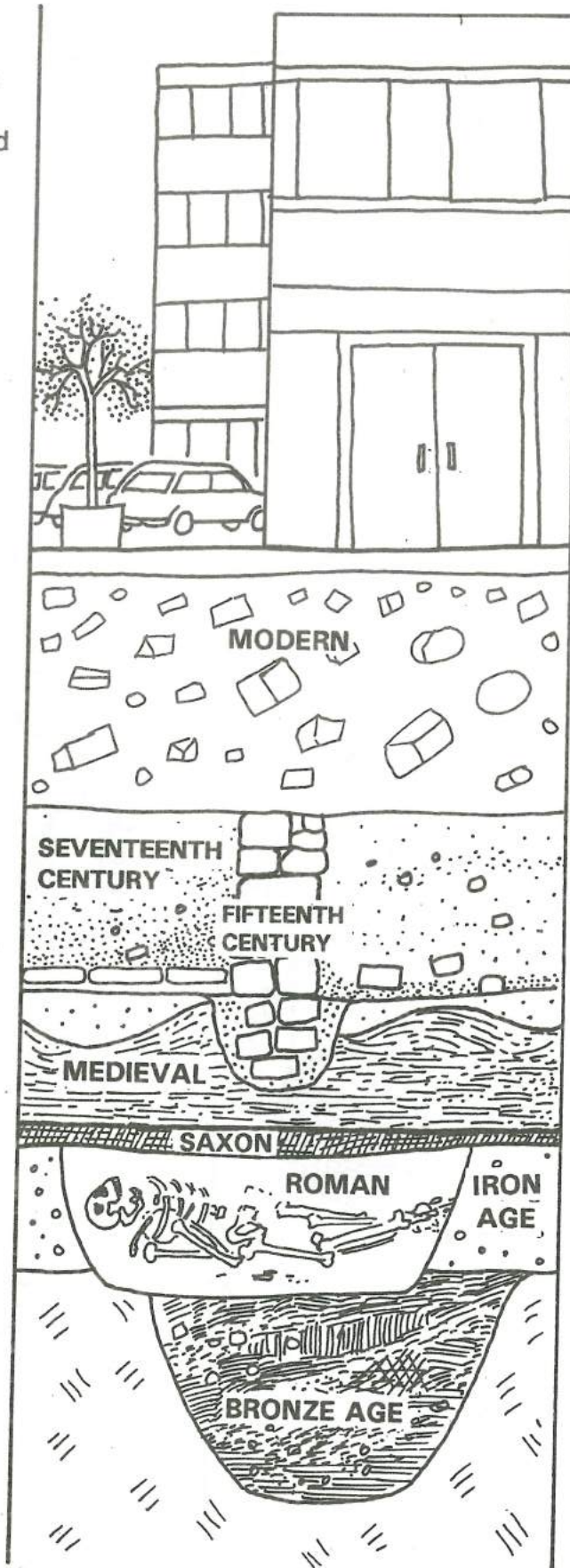

horseshoe
A.D.1650



thirteenth
century
jug



fourth century
human leg bone

A.D.1990
coin



First century B.C.
storage jar

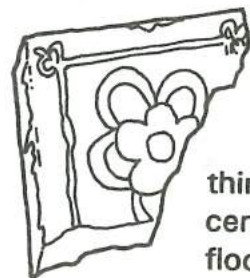

thirteenth
century
floor tile

Object Search

Look closely at the drawings on these two pages.

Colour those objects that an archaeologist might find on an excavation.

Next to the drawings list the objects that an archaeologist might find **only** on a waterlogged site.



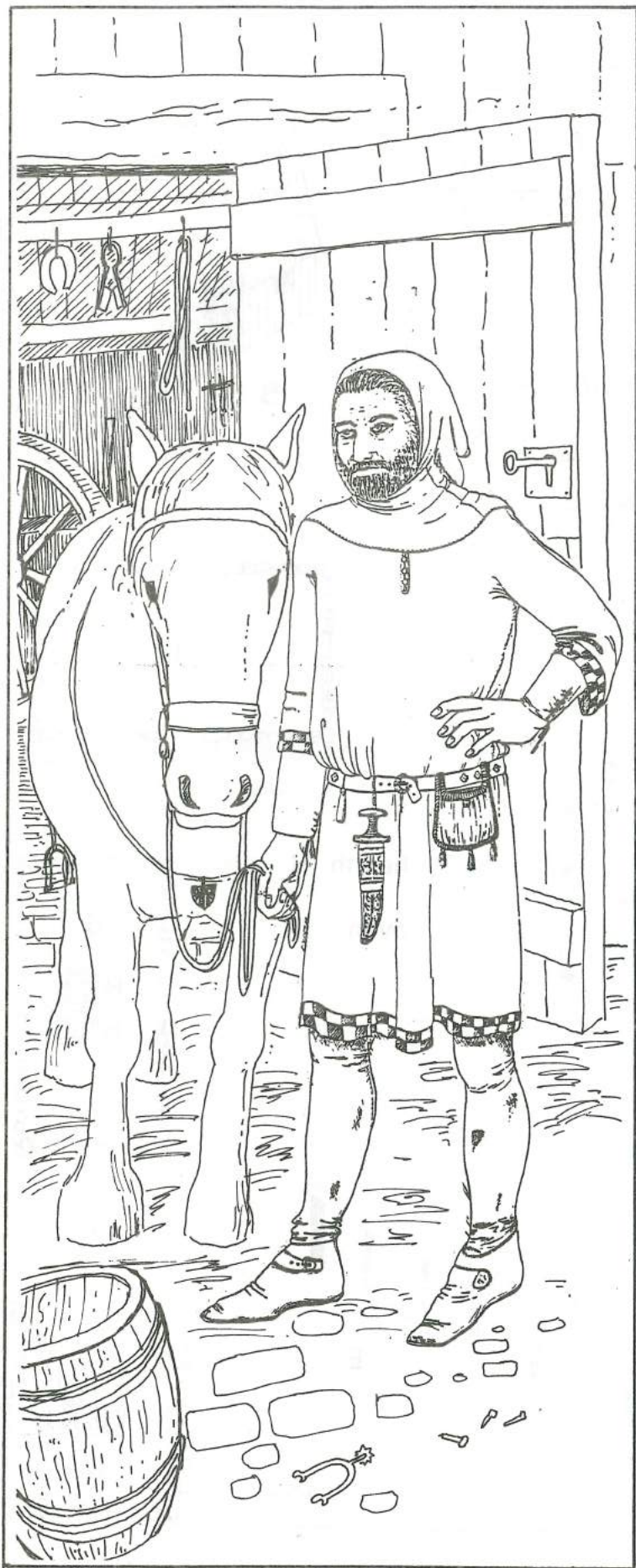

Building Reconstructions

Which of the archaeological plans below (1-6) goes with each of the reconstructed buildings (A-E) ? There will be one plan left over.

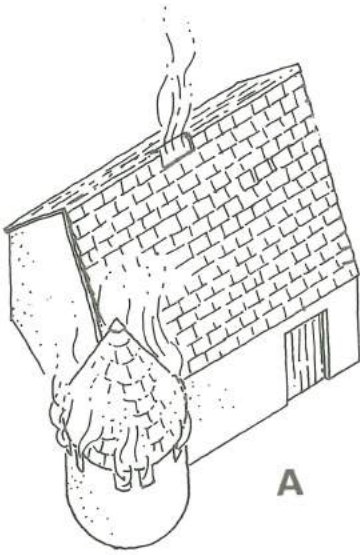

A

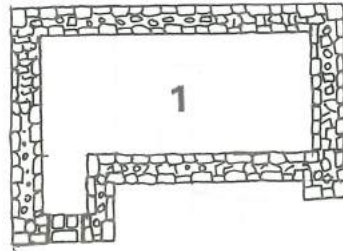

1

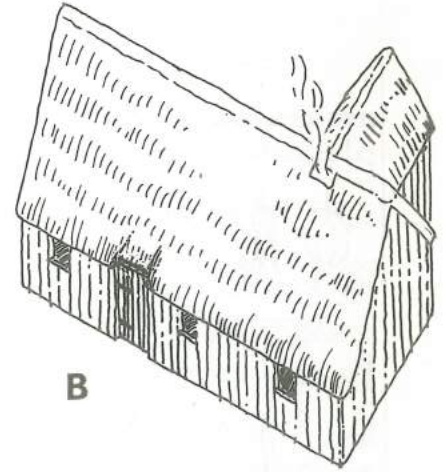

B

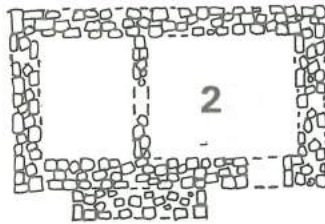

2

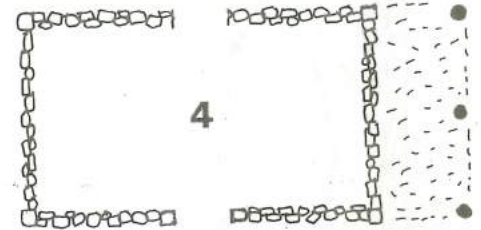

4

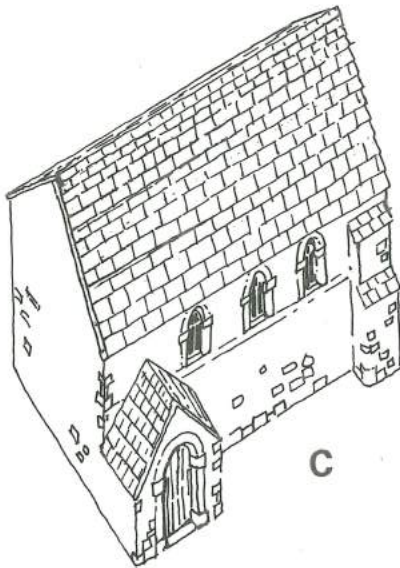

C

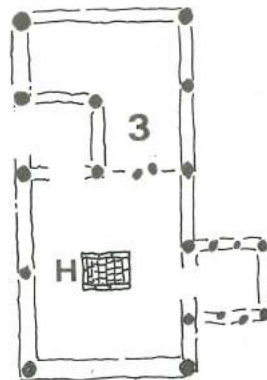

3

hearth H

oven O

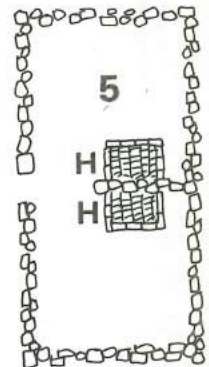

5



D

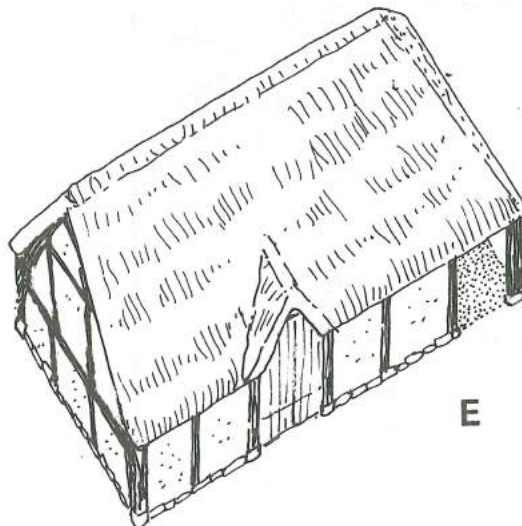

E

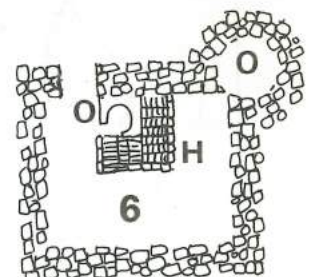

6

0 5 10m

On this page draw your own idea of the building belonging to the plan that is left over.

Look closely at the drawings of the buildings and answer these questions about each one.

What is the roof made of?

A

B

C

D

E

What are the walls made of?

A

B

C

D

E

Using the scale at the bottom of the previous page, calculate the internal area of each building.

A

B

C

D

E

The VILLAGE of MILLBROOK END

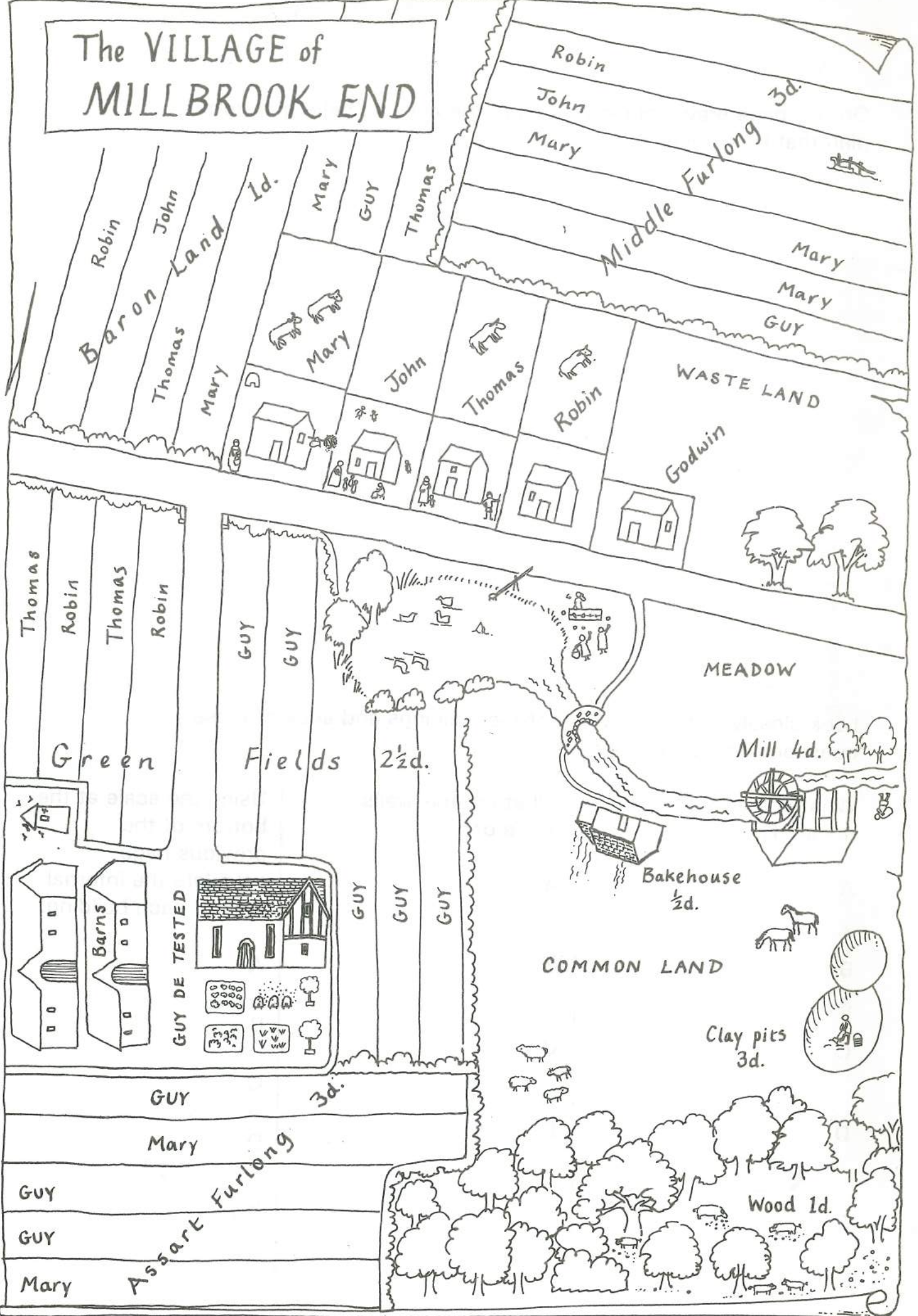

The VILLAGE of
MILLBROOK END

Baron Land
Robin
John
Thomas
Mary

Middle Furlong 3d.
Robin
John
Mary
Mary
Mary
GUY

Id.
Mary
Guy
Thomas
Mary
John
Thomas
Robin

WASTE LAND
Godwin

Green
Thomas
Robin
Thomas
Robin

Fields 2½d.
GUY
GUY
GUY
GUY
GUY
GUY

MEADOW

Mill 4d.

Bakehouse
½d.

COMMON LAND

Clay pits
3d.

GUY 3d.

Mary

GUY

GUY

Mary

Assart Furlong

Wood 1d.

The Village of Millbrook End

The year is 1250. Part of Guy de Tested's manor lies in the village of Millbrook End. He gets an annual payment from his villeins for the use of his woods, his mill and his bakehouse. The potter in the village also pays him an annual rent for digging clay from the common land. The value of each strip of land depends on which furlong it lies in. Each villein pays an annual rent for his/her strips.

Look at the village plan and answer the following questions:

1. How much is Guy de Tested's land worth?
(Remember that there are twelve pennies in one shilling.)
2. Using your imagination, who do you think is sitting in the stocks?
What misdemeanour did he/she commit?
3. Godwin has no strips in the fields. Using your imagination, how do you think he makes his living?
4. Which buildings usually found in a village of the medieval period are not on this part of the plan?
5. How does Mary earn her living?

The first letter of each answer spells a very important event in English history.

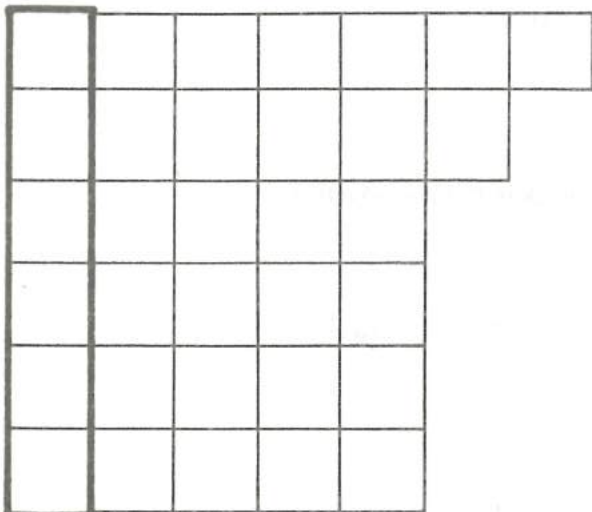

A city in East Anglia famous for its medieval castle and cathedral.

A man expelled from society (like Robin Hood).

The Lord of the manor's deputy, a bailiff.

"- - - - and bailey" castle.

A large religious building- there is one at Westminster.

A medieval gold coin.

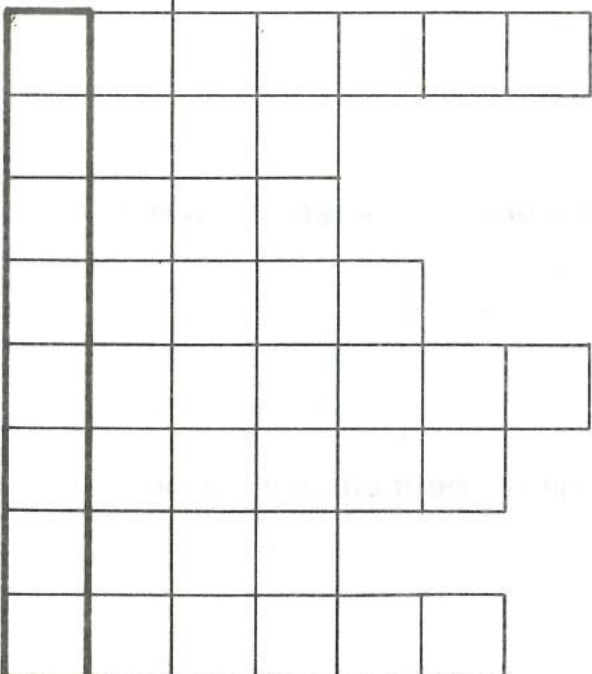

He wrote about pilgrims travelling to Canterbury

Bedford's river-an important trade route in medieval times.

Part of the church where the congregation sits

A stone implement for grinding corn etc.

Mythical heraldic beast (on the royal arms of England).

The first king of this name came to the throne in 1272.

A medieval peasant, tied to his lord.

A man who turned animal skins into leather.

The important event was

its date?



In this picture on the front and back covers there are some deliberate mistakes. The artist has drawn 12 things that would not be found in medieval times. Put a ring round each one that you find, then colour the picture.

